

XFLM Revit Installation Instructions

- Download the XFLM Light Fixture (YM-Yoke Mount or Arm Mount) & the XFLM Mount files
- Load into Revit Project
- Place XFLM Mount in the desired location – Make sure to choose the proper mount type
- Switch to a side elevation view

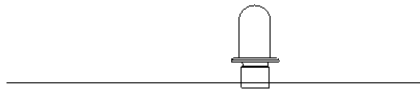

- Draw Reference Planes (located in the “Work Plane” section of the Arch Tab) indicating the rotational axis of the fixture/mount

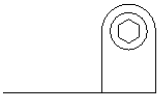
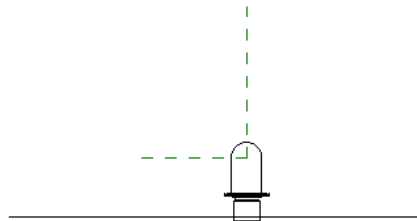
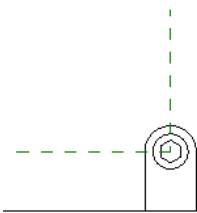

- Switch back to a plan view
- From the plan view place the XFLM Light Fixture centered over the mount

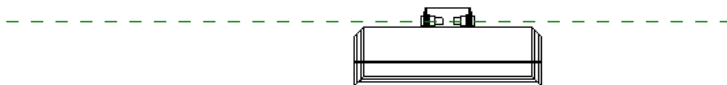
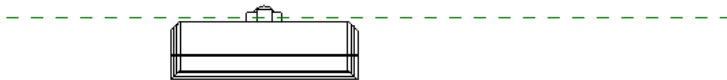

- Switch back to the side elevation



- Select the XFLM Fixture
- From the “Modify | Lighting Fixtures Tab” select “Edit Work Plane”

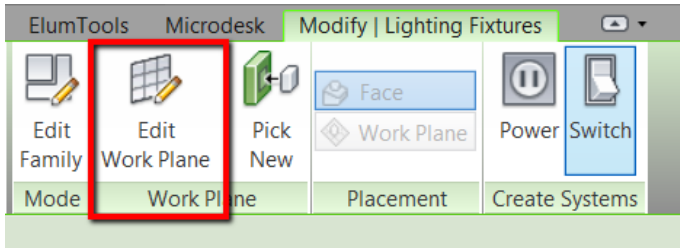

- When the dialog box opens select “Pick a Plane” ---> OKAY
- Select the horizontal reference plane
- Use the “Align - AL” tool from the “Modify Tab” to Align & Lock the XFLM fixture to both the horizontal and vertical reference planes



- Once fixture is locked to both planes use “Ctrl” to select both planes at once
- Navigate to the “Modify Tab” and select the “Rotate – RO” tool
- Select the “Place” option and choose the intersection of the reference planes

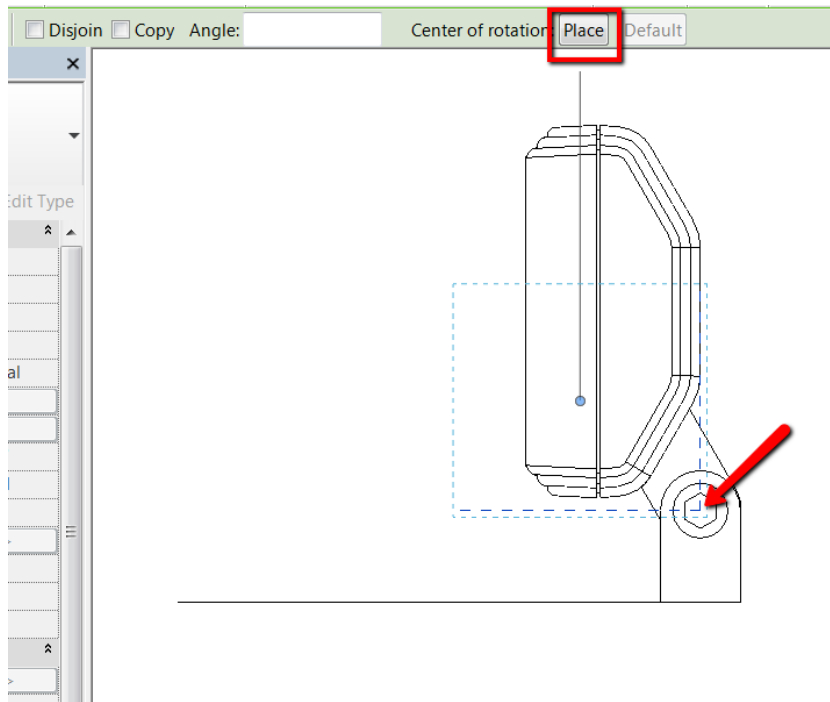

- Click to start the rotation then drag to place or enter the desired angle value

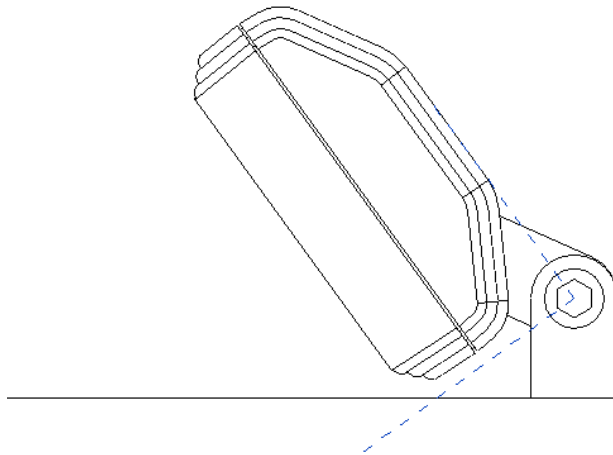

*****KEEP IN MIND. TILT ANGLE IS LIMITED TO MANUFACTURER SPECS. ARM PROVIDES 185° RANGE OF MOTION. KNUCKLE LOCKING PLATE TEETH AND ARM ALLOW FOR TILT/AIMING IN 7.5° INCREMENTS. AIMING ANGLE MARKINGS IN 15°.**

